



### 4

ピン番号	8	7	6	5	4	3	2	1
T568B	茶	茶/白	緑	青/白	青	緑/白	橙	橙/白

- 1番から8番ピンまで一列にして、ディバイダーから25mmほど空けて導線を斜めにカットします。(ロードバーの挿入が容易になります)

### 5

向きに注意してください

- 左側が茶色となるようにディバイダーを持ち、ロードバーの平らな面が表になっている事を確認してロードバーを挿入します。

### 6

### 7

- ディバイダーとの隙間ができる限りできないようにロードバーをしっかりと挿入します。
- ロードバーの先端で余分な導線をカットします。

### 8

カラーの突起

- 図のようにカラーの向きを確認して、可能なところまでハウジングに挿入します。

**【注意】**  
一度挿入した後にケーブルを抜くと、ハウジングにロードバーが残ってしまい、その後成端ができなくなります。

### 9

### 10

MPT5-8AS

- 補助工具CSPTを使用して、ラッチするまでブーツごとストレイリリーフカラーを挿入します。
- 圧着工具 MPT5-8AS を使用して一括圧接します。

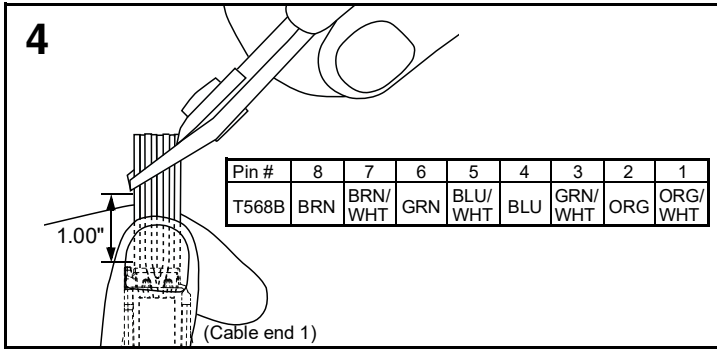

- Straighten and align untwisted conductors using a circular motion while holding conductors in respective divider slots.
- Maintain grip of conductors in T568B wiring scheme.
- Trim conductors on an angle approximately 1.00" from divider leading edge.

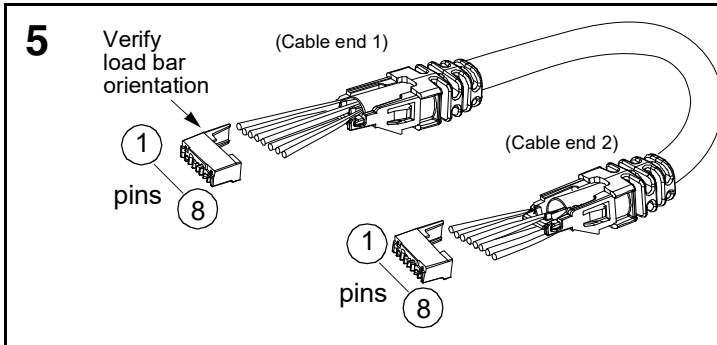

- Orient load bar with contact slots facing downward.

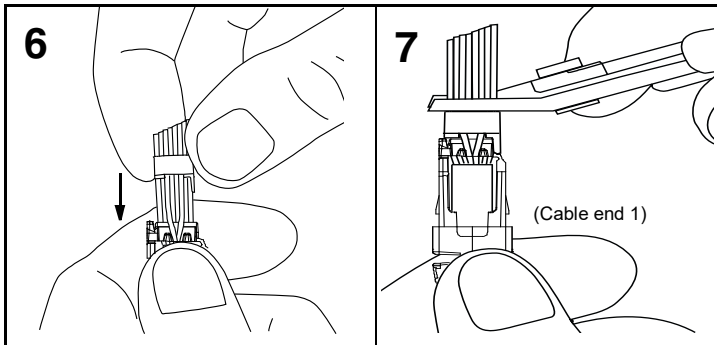

- Guide conductors into load bar holes while holding conductors in the divider.
- Slide load bar towards divider until flush.
- Ensure the divider/load bar is centered and perpendicular to the cable axis.
- Trim conductors flush with load bar face.

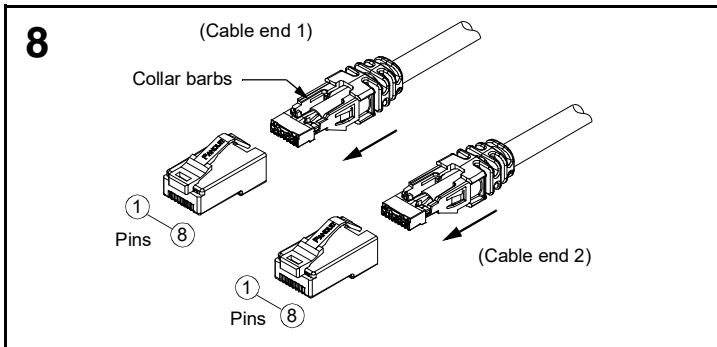

- Confirm the divider is still locked in the strain relief collar.
- Confirm the cable jacket extends beyond the collar barbs.
- Align pin #1 of cable sub-assembly (cable, load bar, and strain relief collar) with pin #1 of plug housing.

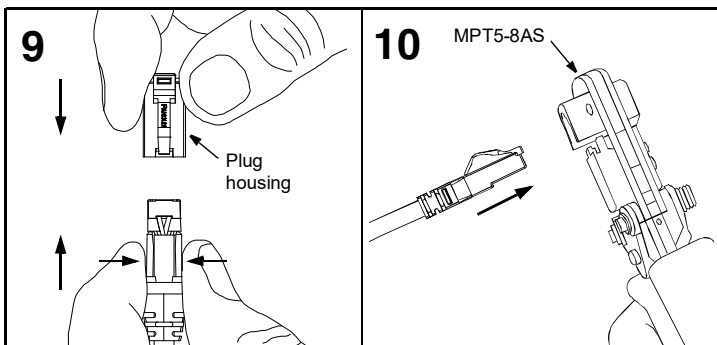

- Grip the strain relief collar and insert cable sub-assembly into the plug housing. (Fig. 9)
- Push sub-assembly into housing until collar locking tabs engage the plug housing pocket. Although not required, TX6 PLUS Plug Assembly Tool (CSPT) is available to facilitate this step.
- Use tool MPT5-8AS to complete plug termination. (Fig. 10)
- Visually check plug. Assembly is complete.

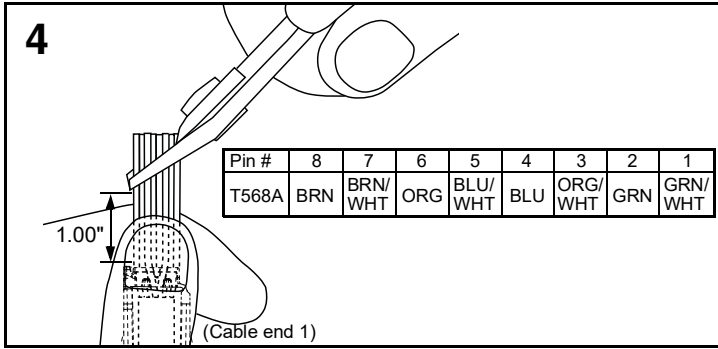

- Straighten and align untwisted conductors using a circular motion while holding conductors in respective divider slots.
- Maintain grip of conductors in T568B wiring scheme.
- Trim conductors on an angle approximately 1.00" from divider leading edge.

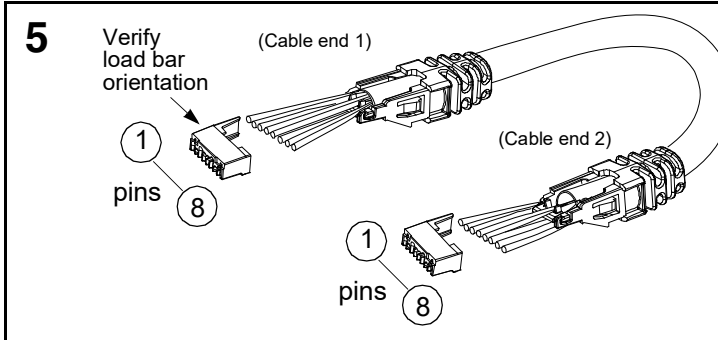

- Orient load bar with contact slots facing downward.

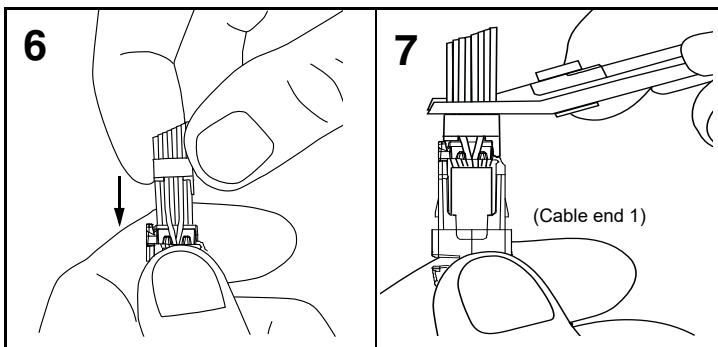

- Guide conductors into load bar holes while holding conductors in the divider.
- Slide load bar towards divider until flush.
- Ensure the divider/load bar is centered and perpendicular to the cable axis.
- Trim conductors flush with load bar face.

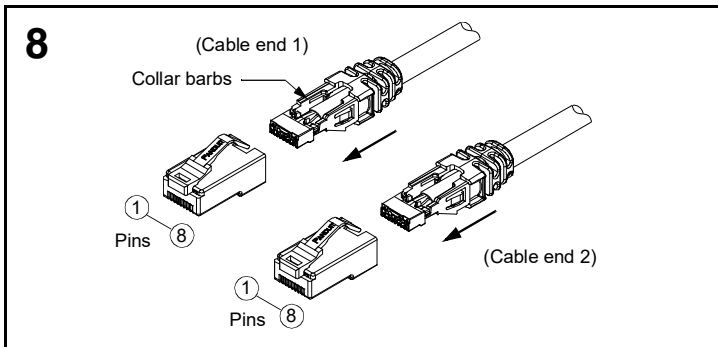

- Confirm the divider is still locked in the strain relief collar.
- Confirm the cable jacket extends beyond the collar bars.
- Align pin #1 of cable sub-assembly (cable, load bar, and strain relief collar) with pin #1 of plug housing.

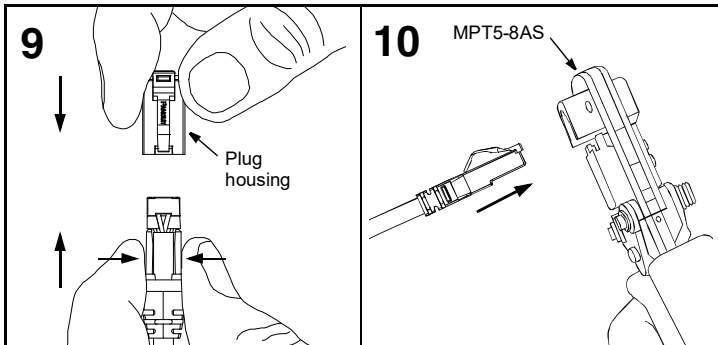

- Grip the strain relief collar and insert cable sub-assembly into the plug housing. (Fig. 9)
- Push sub-assembly into housing until collar locking tabs engage the plug housing pocket. Although not required, TX6 PLUS Plug Assembly Tool (CSPT) is available to facilitate this step.
- Use tool MPT5-8AS to complete plug termination. (Fig. 10)
- Push up boot and engage with collar latches.
- Visually check plug. Assembly is complete.